

Pump Collection

QUALITY, EXPERIENCE, INNOVATION !!





Breakthrough Technology & World Class Quality

Equip Your Products with Competency and Reliability,
Guaranteed by History of Engineering Excellence.

CSE has over twenty five years of experience in designing and manufacturing a wide variety of water and air pumps used in an ever expanding variety of markets and applications throughout the world.

Ranging from diaphragm booster pumps to gear pumps, CSE thrives to satisfy rapidly changing environments and requirements of today's market. CSE pumps are designed for longevity to guarantee longer life expectancy for your prospective and respective applications.

Whatever your need is, CSE pumps will provide you with a durable high quality solution.

HISTORY

1988 04. Company establishment	1996 07. Acquired ISO-9001	2003 03. Began Vacuum Food Storage System business for domestic & overseas markets	2006 04. Selected as a Venture Company
1988 10. Began boiler pumps business	1997 03. Selected as a promising small and medium company by Gyeonggi Province	2003 06. Moved company headquarters to Ansan-City, Gyeonggi Province	2006 04. Awarded INNO-BIZ
1993 08. Moved headquarters to Shiwha Industrial Complex	1999 03. Awarded by minister of Tax Administration Agency	2004 02. Acquired UL & NSF approval for coffee machine circulation pumps	2008 10. Moved company headquarters to Siheung-City, Gyeonggi Province
1995 01. Received commendation for research and high performance technology from the Ministry of Trade	2000 12. Acquired CE mark for diaphragm booster pumps	2004 05. Awarded Order of Industrial Merit by Government	2008 10. Selected as a Frontier Company by Gyeonggi Province
1995 03. Began coffee grinder and vending machine pump businesses for domestic & overseas markets	2002 02. Split company to CSE Co., Ltd. and Chungbuk Co., Ltd.	2004 09. Acquired ISO-14001	2009 09. Began Boiler Mattress System business
1996 07. Began water purifier pump & hydroponics pump businesses for domestic & overseas markets	2002 10. Acquired ISO-9001 : 2000	2005 11. Exclusive Agency Agreement with Delonghi (Italy)	2010 11. Moved to new headquarters building in Siheung City
	2002 10. Established R & D Center for CSE Co., Ltd.	2005 12. Established "Freshfield" brand for Vacuum Food Storage System	2012 03. Began air pump business for fuel cell application with Fujikura composite



CS-0112P/Q (BLDC)

DIMENSIONS ▾

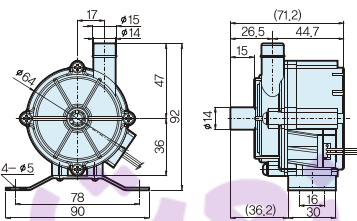

PERFORMANCE CURVE ▾

ROOM TEMP : 24°C, WATER TEMP : 24°C,
POWER SUPPLY : DC 12V(0112P), DC 24V(0112Q)

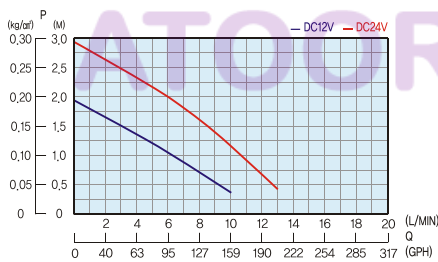

CS-0113B

DIMENSIONS ▾

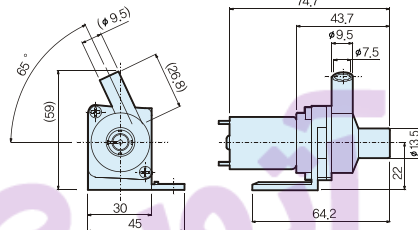

PERFORMANCE CURVE ▾

ROOM TEMP : 24°C, WATER TEMP : 24°C,
POWER SUPPLY : DC 12V, DC 24V

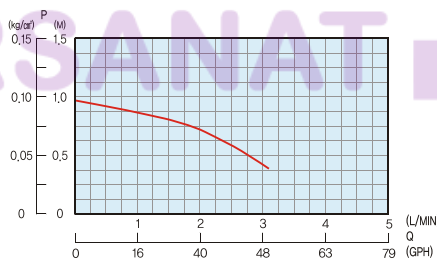

MP-010A/B/C

DIMENSIONS ▾

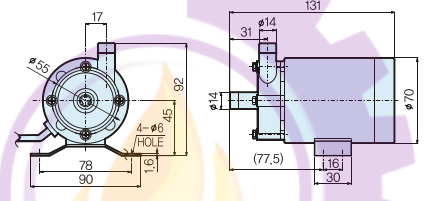

PERFORMANCE CURVE ▾

ROOM TEMP : 24°C, WATER TEMP : 24°C,
POWER SUPPLY : AC 120V 60Hz(010A), AC 220V 60Hz(010B)
AC 100V 60Hz(010C)

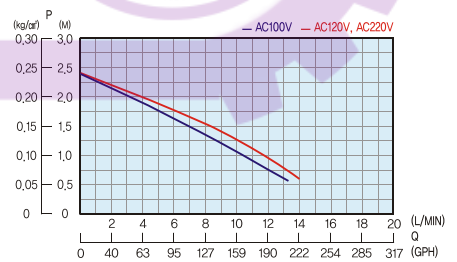

NOTE : The performance illustrated is based on pumping water at ambient temperature. / Specifications and dimensions are subject to change upon your requests.

SPECIFICATIONS

ITEM	MODEL	CS-0112P(BLDC)	CS-0112Q(BLDC)	CS-0113B-YW	CS-0113B-RD	MP-010A/B	MP-010C
Power Supply		DC12V	DC24V	DC12V	DC24V	AC120V/220V,60Hz	AC100V,60Hz
Input		8W	15W	1.5W	1.7W	19W/14W	15W
Maximum Current		0.66A	0.61A	0.13A	0.07A	0.15A	0.15A
Maximum Head		1.9M(6.2ft)	2.9M(9.5ft)	0.9M(2.9ft)	0.9M(2.9ft)	2.4M(7.9ft)	2.4M(7.9ft)
Maximum Capacity		10 l /min (159GPH)	13 l /min (206GPH)	3.0 l /min (48GPH)	3.0 l /min (48GPH)	14 l /min (222GPH)	13 l /min (206GPH)
Water Temperature		0°C ~ 70°C		0°C ~ 50°C		0°C ~ 80°C	
Hose Connected[mm]	Inlet	Ø14		Ø13.5		Ø14	
	Outlet	Ø14		Ø9.5		Ø14	
Dimension[mm]		71.2*90*92		74.7*45*59		131*90*92	

Magnetic Drive Pumps

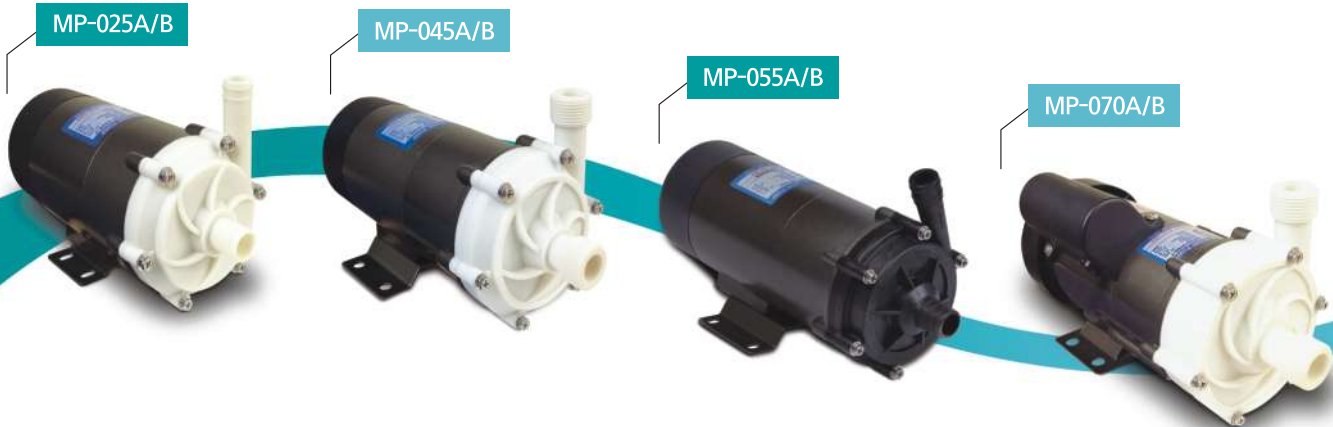

MP-025A/B

DIMENSIONS

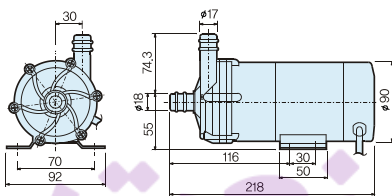

PERFORMANCE CURVE

ROOM TEMP : 24°C, WATER TEMP : 24°C,
POWER SUPPLY : AC 120V 60Hz, AC 220V 60Hz

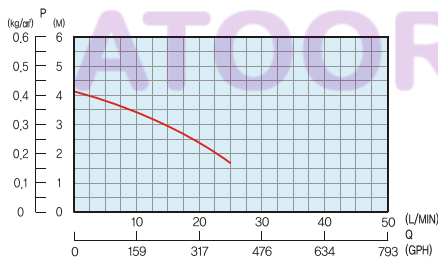

MP-055A/B

DIMENSIONS

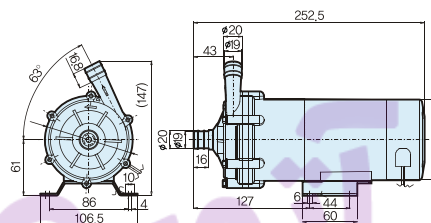

PERFORMANCE CURVE

ROOM TEMP : 24°C, WATER TEMP : 24°C,
POWER SUPPLY : AC 120V 60Hz, AC 220V 60Hz

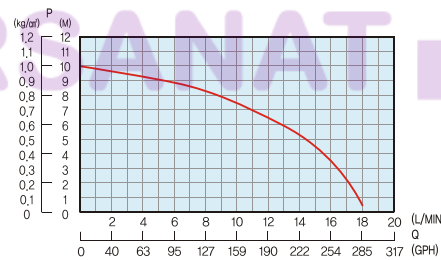

MP-070A/B

DIMENSIONS

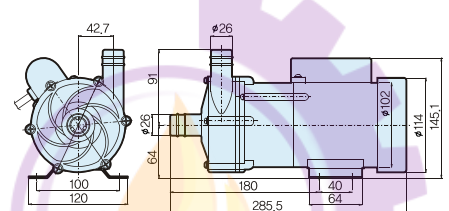

PERFORMANCE CURVE

ROOM TEMP : 24°C, WATER TEMP : 24°C,
POWER SUPPLY : AC 120V 60Hz, AC 220V 60Hz

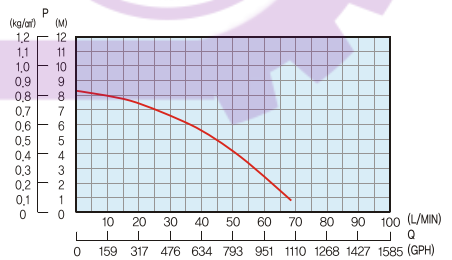

NOTE : The performance illustrated is based on pumping water at ambient temperature. / Specifications and dimensions are subject to change upon your requests.

SPECIFICATIONS

ITEM	MODEL	MP-025A/B	MP-045A/B	MP-055A/B	MP-070A/B
Power Supply		AC120V/220V,60Hz	AC120V/220V,60Hz	AC120V/220V,60Hz	AC120V/220V,60Hz
Input		41W/39W	70W/64W	103W/93W	150W/145W
Maximum Head		4.0M(13.1ft)	4.5M(14.8ft)	10M(32.8ft)	8.0M(26.2ft)
Maximum Capacity		24 l / min (380GPH)	44 l / min (697GPH)	19 l / min (301GPH)	70 l / min (380GPH)
Water Temperature		0°C ~ 80°C	0°C ~ 80°C	0°C ~ 80°C	0°C ~ 80°C
Hose Connected[mm]	Inlet	Ø18	Ø20	Ø20	Ø26
	Outlet	Ø17	Ø20	Ø20	Ø26
Screw Connected	Inlet	PF 3/4"	PF 3/4"	-	PF 1"
	Outlet	PF 3/4"	PF 3/4"	-	PF 1"
Dimension[mm]		218*92*129.3	258*120*136.5	252.5*106.5*147	285.5*120*155

Pump Collection

- Gear Pumps
- Diaphragm Booster Pumps
- Magnetic Drive Pumps
- Mechanical Seal Water Pumps
- Self-Priming Pumps
- Air Pumps & Vacuum Pumps
- Air Compressors

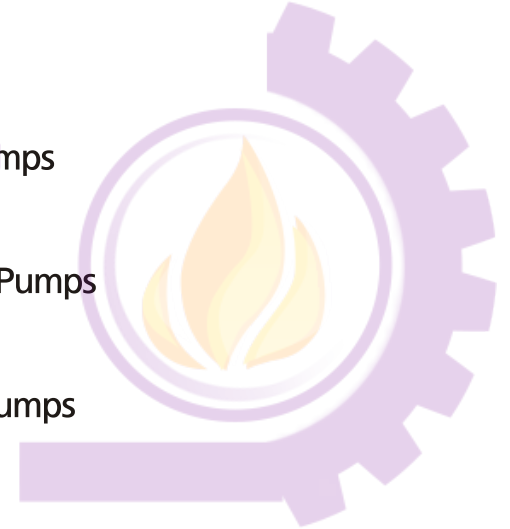

Certificates

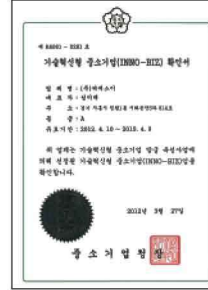

INNO-BIZ



ISO 9001



ISO 14001



CSE CO., LTD.

3Ra 814, Shiwha Industrial Complex,
118 Mayu-ro, Siheung-si, Gyeonggi-do,
South Korea (429-854)

TEL : +82-31-488-8171 FAX : +82-31-499-2486

