



### Application

- To transfer clean water with liquid temperature between 0°C and 40°C
- Application in water supply and drainage for factories, mines, municipal facilities as well as field irrigation, ect.

### Features

- New unique design with ergonomic feature
- Portable and compact pump frame
- High quality motor with excellent performance and long service life
- Impeller designed with high efficiency hydraulic system
- Low fuel consumption

### Engine

- Single cylinder, 4-stroke, air cooled
- Max. power :4 HP
- Displacement: 207 cc
- Rated speed: 3000±150pm

### Identification Codes

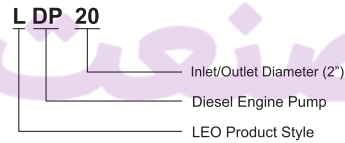

### Technical Data

MODEL	POWER HP	Q (m <sup>3</sup> /h) Q (l/min)	H (m)													
			0	5	10	15	20	25	30	35	40	45				
LDP20	4	0	83.3	166.7	250	333.3	416.7	500	583.3	666.7	750	-	-	-	-	-
LDP30	4	0	83.3	166.7	250	333.3	416.7	500	583.3	666.7	750	18	17	15	12.5	8

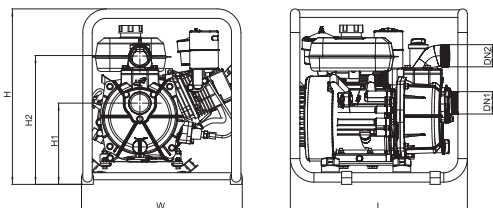

### Dimension

Model	DN1	DN2	L (mm)	W (mm)	H (mm)	H1 (mm)	H2 (mm)
LDP20	2"	2"	470	427	466	181	341
LDP30	3"	3"	470	427	466	225	378

### Hydraulic Performance Curves

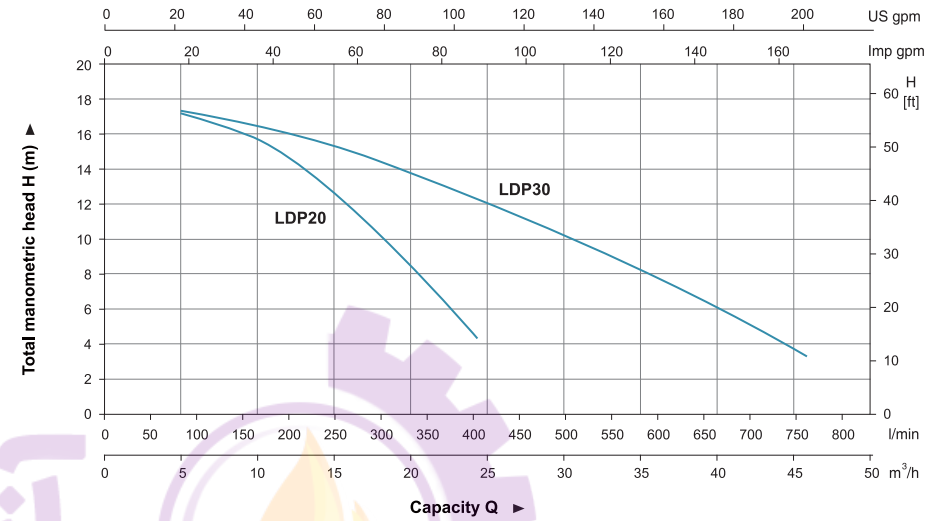

### Materials Table

No.	Part	Material
1	Damper	
2	Frame	Steel
3	Diesel engine	
4	Pump cover	Aluminum
5	Mechanical seal	Carbon/Ceramic
6	O-ring	NBR
7	Impeller	HT200
8	Diffuser	HT200
9	Seal ring	NBR
10	O-ring	NBR
11	Plug	ABS
12	Outlet	Aluminum
13	Gasket	NBR
14	Pump body	Aluminum
15	One-way valve	NBR
16	Inlet	Aluminum

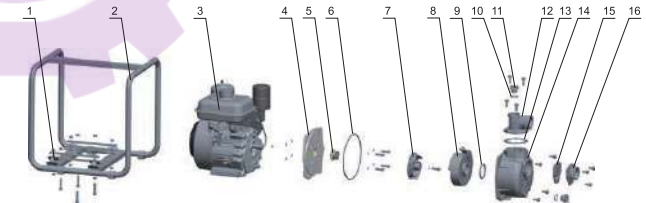

### Package Information

Model	GW (Kgs)	L (mm)	W (mm)	H (mm)	Quantity (PCS/20 TEU)
LDP20	30.7	485	435	505	244
LDP30	31.7	485	435	505	244

